



*Baltimore Regional Transportation Board*

---

# Transportation Alternatives (TA) Program FY 2023 Applications

BRTB

September 27, 2022



# TA/SRTS Program Applications



- **MDOT SHA Call for Projects – applications due mid-May**
- **MDOT SHA and BMC conducted site visits and reviewed applications**
- **Funds Available: Baltimore region**
  - \$6,512,687.75 available in FY 2023
  - Seven applications received, totaling \$6,040,549.75 in requests
- **Funds Available: Aberdeen/Bel Air South/  
Bel Air North**
  - \$631,718.84 in FY 2023
  - Also, \$211,485 from FY 2022, \$207,386 from FY 2021 and \$207,386 from FY 2020. Total = \$1,257,975.84
  - No applications received

# TA: Anne Arundel County Baybrook Connector

## Nursery Road Light Rail Station to Potee St/MD 2

### Anne Arundel County



# Anne Arundel County Baybrook Connector

Nursery Road Light Rail Station to Potee St/MD 2 (2.15 miles)

**Type:** Design

**Total Cost:** \$900,000

- Requested: \$750,000
- Match: \$150,000 (20%)

**Summary:** 30 – 100% design of Baybrook Connector shared use path/cycle track in Anne Arundel County

**Purpose:** Provide safe access for pedestrians and bicyclists living in one of the most underserved portions of the County:

- Connect to BWI Trail Loop Spur (which connects to B&A Trail)
- Provide access to Nursery Road Light Rail Station
- Planned segment in Baltimore City would provide access to health care, Middle Branch Waterfront, Gwynns Falls Trail



# SRTS: Hammonds Ferry School Sidewalk

Hammonds Ferry Road from Kingbrook Road to Kingwood Road  
Anne Arundel County



# Hammonds Ferry School Sidewalk

Hammonds Ferry Road from  
Kingbrook Road to Kingwood Road (1,500 feet)

**Type:** Construction

**Total Cost:** \$620,000

- Requested: \$495,000
- Match: \$125,000 (25%)

**Summary:** Construction of sidewalk in Anne Arundel County

**Purpose:** Provide pedestrian infrastructure for children within the walk zone of Linthicum Elementary School

- ADA compliant sidewalk
- Connect to existing sidewalk north of the Kingbrook Road intersection
- Request from the Anne Arundel County Public School Transportation Division



# SRTS: Reece Road Sidewalk

Reece Road from Meade Heights Elementary  
to Severn Intergenerational Center  
Anne Arundel County



# Reece Road Sidewalk

Reece Road from Meade Heights Elementary  
to Severn Intergenerational Center (2,600 feet)

**Type:** Design

**Total Cost:** \$349,000

- Requested: \$273,000
- Match: \$76,000 (28%)

**Summary:** Design of sidewalk in Anne Arundel County along north side of Reece Road from Meade Heights Elementary to Severn Intergenerational Center

**Purpose:** Connect the community to the Meade Heights Elementary and the new Severn Intergenerational Center and existing Van Bokkelen Elementary School



# TA: West East Express (WEE) Trail

## People's Park to Admiral Dr at Poplar Ave

### City of Annapolis

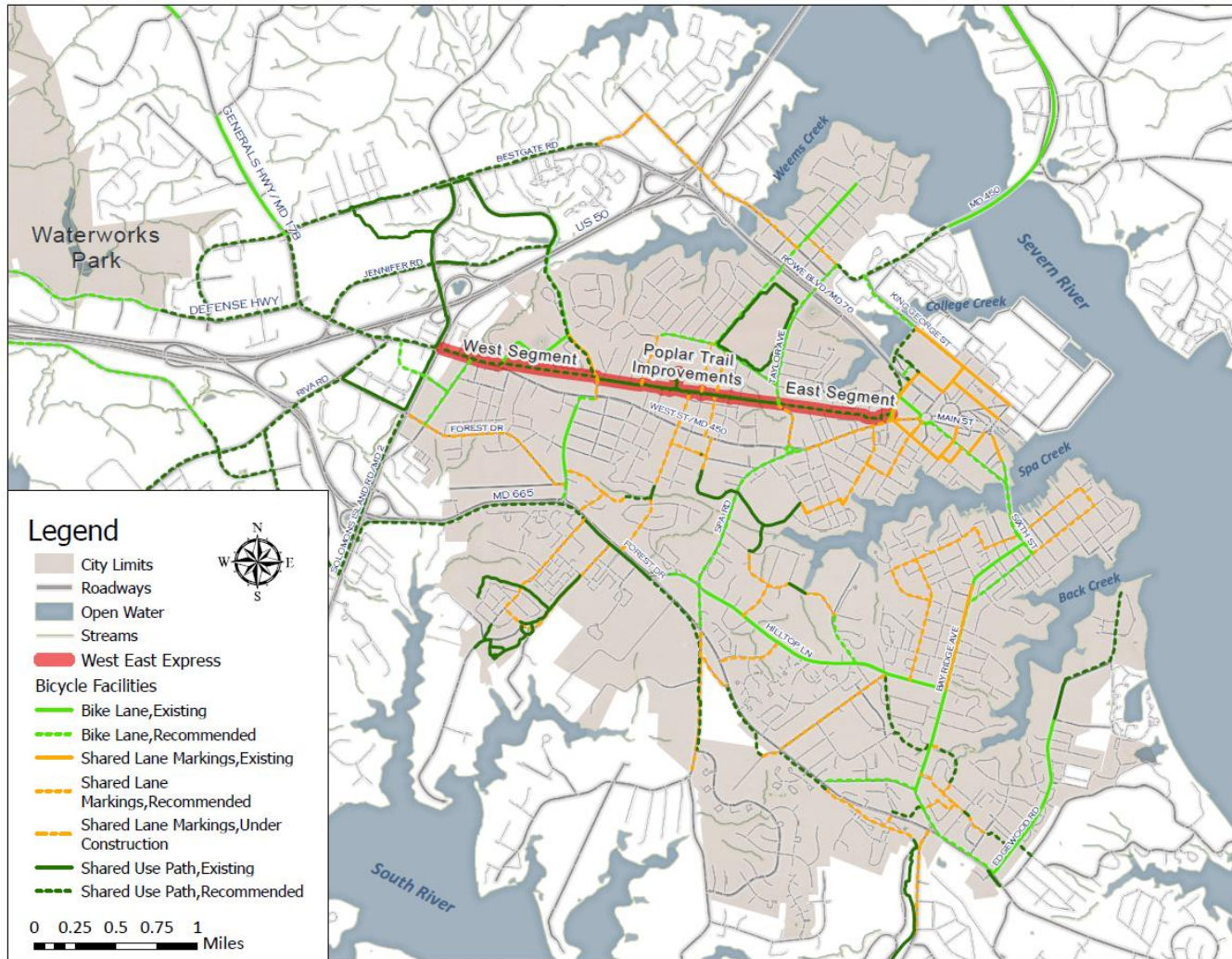

# **West East Express (WEE) Trail**

## People's Park to Admiral Dr at Poplar Ave (1.86 miles)

**Type:** Construction

**Total Cost:** \$2,402,400

- Requested: \$2,002,000
- Match: \$400,400 (20%)

**Summary:** Shared use path and sidepath to improve the existing Poplar Trail and extend east to Downtown Annapolis. Construction of the WEE - East Segment and widening of the existing Poplar Trail (currently 6').

**Purpose:** Capitalize on the most heavily biked trail in Annapolis and link to B&A Trail and South Shore Trail to create a large regional trail loop. Increase equity and provide alternative transportation options to communities along alignment



# SRTS: Cecil Elementary

22<sup>nd</sup> Street from Cecil Avenue to Boone St and  
Kirk Avenue at Homewood Avenue  
Baltimore City

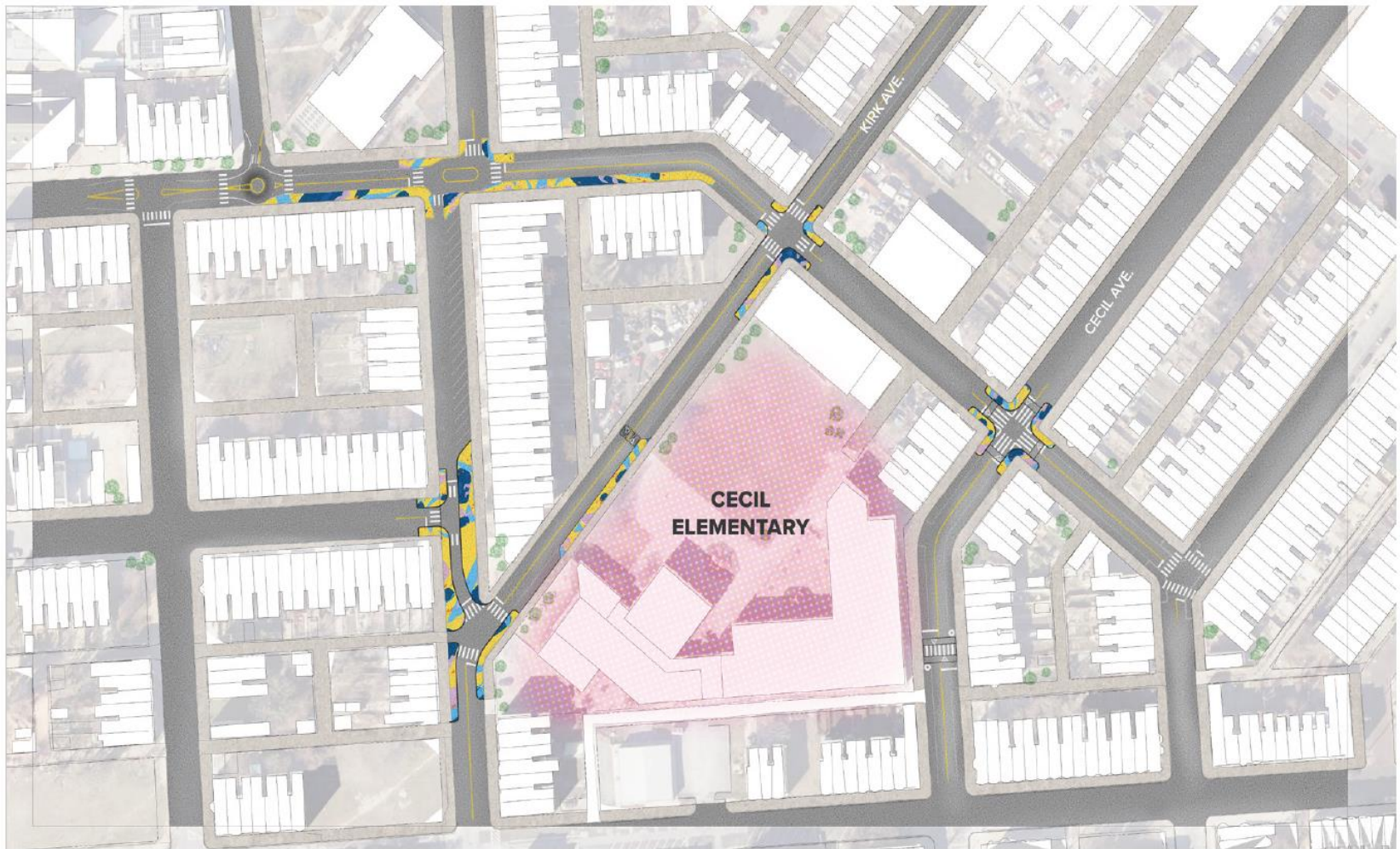

# Cecil Elementary

22<sup>nd</sup> Street from Cecil Avenue to Boone St and  
Kirk Avenue at Homewood Avenue

**Type:** Construction

**Total Cost:** \$478,699.75

- Requested: \$300,049.75
- Match: \$178,650.00 (60%)

**Summary:** Improve ADA enhancements and traffic calming at three intersections in the immediate vicinity of Cecil Elementary, 350 students, and install one mid-block crossing

**Purpose:** Remedy identified safety concerns surrounding Cecil Elementary School and provide safer access to recreation center, pending community play lot project, and after-school childcare center

- ADA compliant curb ramps
- Improve visibility of crosswalk markings
- Encourage driver awareness in school zone



# SRTS: Martin Luther King Jr. Sidepath

Martin Luther King Jr. Boulevard from  
Russell Street to Eutaw Street  
Baltimore City

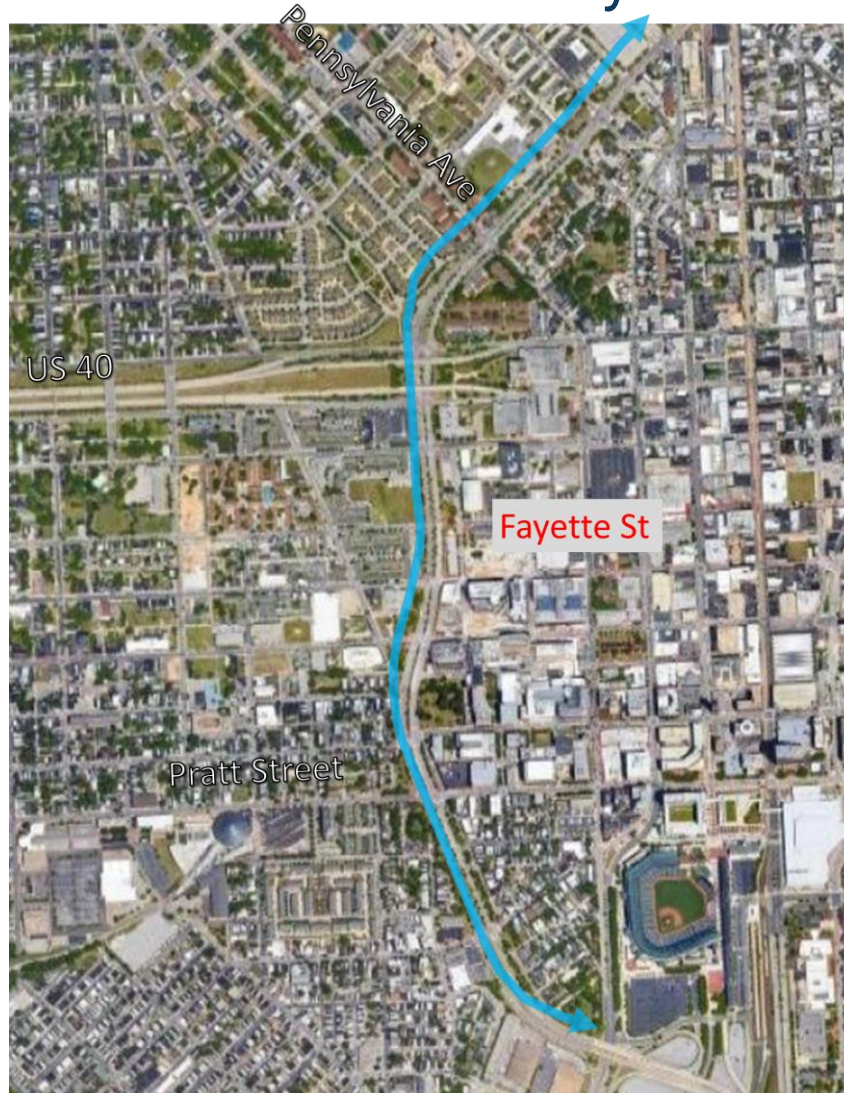

# **Martin Luther King Jr. Sidepath**

## **Martin Luther King Jr. Boulevard from Russell Street to Eutaw Street (2 miles)**

**Type:** Design

**Total Cost:** \$480,000

- Requested: \$400,000
- Match: \$80,000 (20%)

**Summary:** Develop final design plans to transform a sidewalk into a shared use path and add traffic calming measures at intersections

**Purpose:**

- Enable and encourage children to safely walk and bike
- Address ADA compliance issues
- Widen existing path
- Increase safety at intersections and crossings
- Address equity and access
- Enhance multimodal travel and network connectivity

# TA: Patuxent Branch Trail Surface Upgrade

## Trailhead at Old Guilford to Trailhead at Vollmerhausen Road Howard County

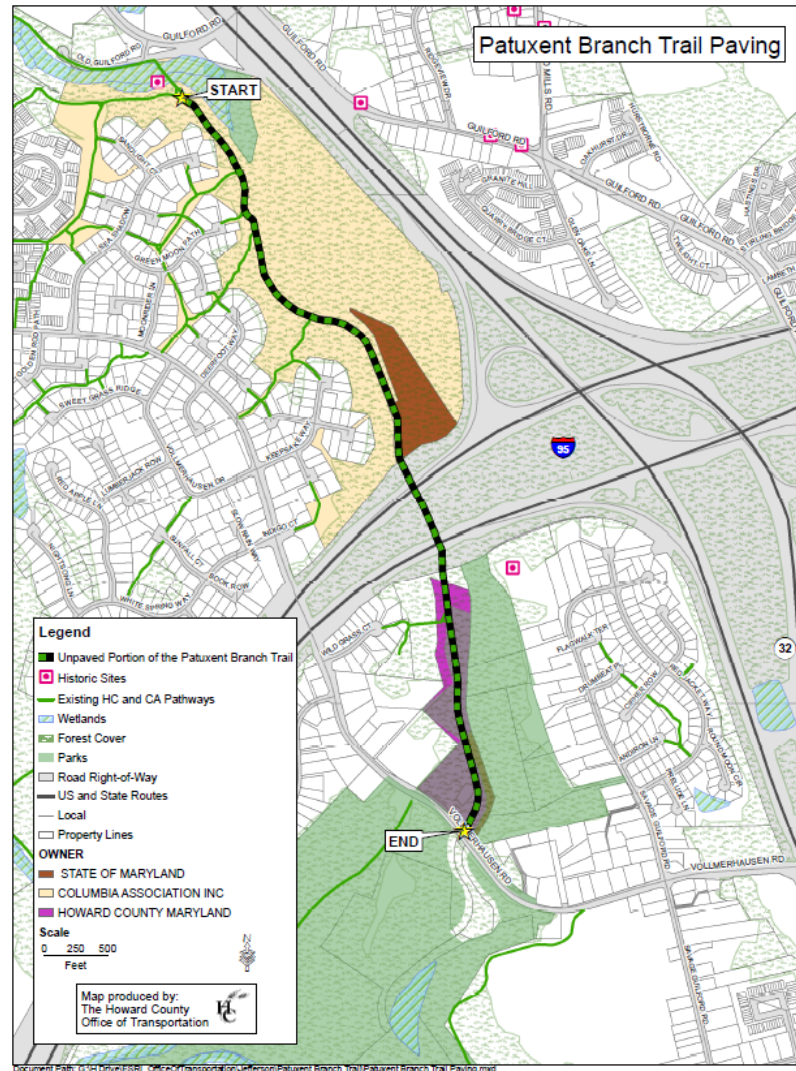

# Patuxent Branch Trail Surface Upgrade

## Trailhead at Old Guilford to Trailhead at Vollmerhausen Road (1.3 miles)

**Type:** Construction

**Total Cost:** \$2,495,500

- Requested: \$1,820,500
- Match: \$675,000 (37%)

**Summary:** Upgrade the surface of the Patuxent Branch Trail from dirt and gravel mix to a firm, weather resistant, ADA compliant surface and upgrade trail crossing of Vollmerhausen Road

**Purpose:** Provide a transportation based shared use path from Columbia to North Laurel and the City of Laurel

- Improve accessibility
- Preserve the natural feel of the area
- Improve safety
- Protect park resources
- Minimize environmental impact
- Manage future maintenance
- Enhance sense of place



# FY 2023 Recommendations

PROJECT	REQUEST	RECOMMENDATION
Anne Arundel County Baybrook Connector	\$750,000	\$750,000
Hammonds Ferry School Sidewalk SRTS	\$495,000	\$495,000
Reece Road Sidewalk SRTS	\$273,000	- -
West East Express Trail	\$2,002,000	\$2,002,000
Cecil Elementary SRTS	\$300,050	\$300,050
Martin Luther King Jr. Sidepath	\$400,000	\$400,000
Patuxent Branch Trail Surface Upgrade	\$1,820,500	\$1,820,500

# For more information

---

**Charlene Mingus** | Active Transportation Planner

410-732-0500 x1008 | [cmingus@baltometro.org](mailto:cmingus@baltometro.org) | [www.baltometro.org](http://www.baltometro.org)



@BALTOMETROCOUNCIL



@BALTIMORE METROPOLITAN COUNCIL



@BALTIMORE METROPOLITAN COUNCIL

